

▼ RT1510, RT3323, RT2111



- Nitrocarburized surface treatment inside and out provides corrosion protection
- 3% side load of full capacity
- Double or triple wear bearings support lifting stages
- Tilting saddles with 5 degrees of maximum tilt standard on all models
- Design Safety factor complies with ASME B30.1 & EN1494
- Certified lifting eyes for safe handling and positioning
- CR400 coupler for compatibility with standard product
- Steel cylinder base for maximum strength.

Moving a load a greater distance



RT-Series, Multi-Stage Cylinders

Enerpac compact, multi-stage telescopic cylinders are available with two or three pistons, and can lift loads up to 24 inches in a single movement.

Nitrocarburized surface treatment inside and out provides unparalleled sideload resistance and corrosion protection for safe use in the harshest conditions. The longer stroke length of telescopic cylinders will save you time and simplify projects by moving a load a greater distance and eliminating the use of temporary cribbing.

Multi-Stage Cylinders

1st Stage: maximum load capacity at lowest maximum stroke

2nd Stage: extended stroke but at lower maximum capacity than the 1st stage

Final Stage: maximum stroke extension but lowest maximum capacity.

WARNING: If several telescopic cylinders need to be controlled simultaneously Enerpac recommend the use of EVO or EVOP-Series Synchronous Lifting Pumps. Enerpac advise not to use SFP-Series Split-Flow pumps to operate several telescopic cylinders at a time due to the volume difference on the different stages.



Tilt Saddles

All RT-Series cylinders include integral tilt saddles with maximum tilt angles up to 5 degree.



◀ The longer stroke length of telescopic cylinders will save you time and simplify projects by moving a load a greater distance and eliminating the use of temporary cribbing.

Cylinder Capacity at Maximum Stroke tons	Maximum Stroke (in)	Model Number	Collapsed Height	Extended Height
			A (in)	B (in)
15.4	10.63	RT1510	11.14	21.77
	17.13	RT1817	13.58	30.71
22.2	11.81	RT2111	12.48	24.29
	19.69	RT2119	15.55	35.24
34.8	11.81	RT3311	13.86	25.67
	23.62	RT3323	18.74	42.36

Multi-Stage Telescopic Cylinders, Single-Acting, Load Return

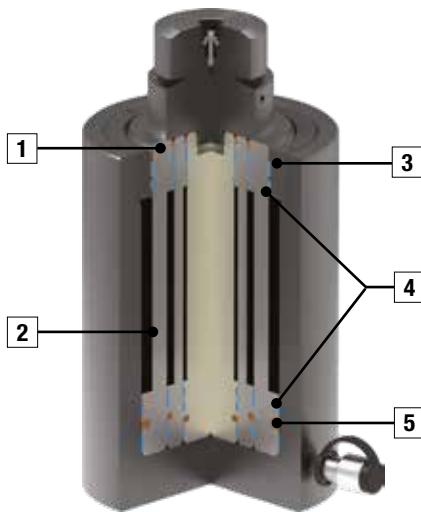

- 1 Wiper Ring** on each stage to minimize contamination.
- 2 Nitrocarburized Coating** for maximum corrosion protection and surface hardness.
- 3 Stop Ring** full load capable to prevent plunger overstroke.
- 4 Wear Bearings.** Double or triple wear bearings for maximum sideload capability and wear resistance.
- 5 Seals** for maximum compliance and high wear resistance.

RT Series



Capacity:
15.4 - 34.8 tons

Stroke:
10.63 - 23.62 inches

Maximum Operating Pressure:
10,150 psi

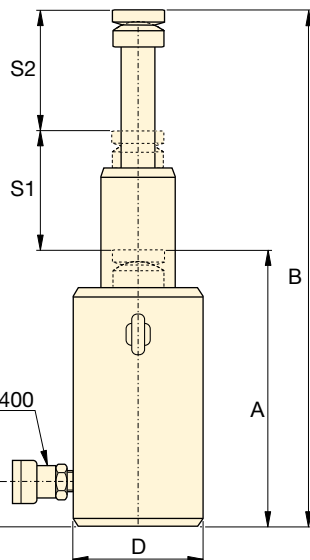
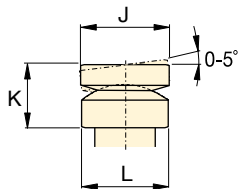

RT1510, 2111, 3311

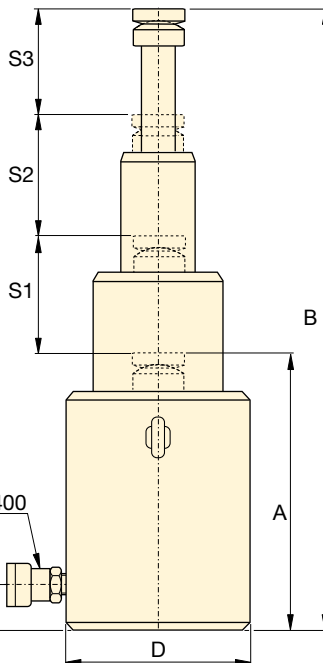

RT1817, 2119, 3323



Assisted-return Pumps with Venturi Valve Technology

ZU4 and ZE-Series pumps feature Venturi Valve Technology to accelerate single-acting gravity and spring-return cylinder retraction speeds. See valve type in ordering matrix and details in section Directional Control Valves. See enerpac.com for details.

Page: 129



Hoses

Enerpac offers a complete line of high-quality hydraulic hoses. To ensure the integrity of your system, specify only Enerpac

hydraulic hoses.

Page: 136

Oil Capacity (in ³)	1st Stage		2nd Stage		3rd Stage		Outside Diameter D (in)	Bottom to Advance Port H (in)	Saddle Diameter J (in)	Saddle Protrusion from Plgr. K (in)	Saddle Support Diameter L (in)	Model Number
	Capacity tons	Stroke S1 (in)	Capacity tons	Stroke S2 (in)	Capacity tons	Stroke S3 (in)						
57.61	40	5.31	15	5.31	-	-	4.33	0.79	2.36	1.93	2.36	RT1510
188.69	104	5.71	45	5.71	18.7	5.71	6.69	1.06	3.15	2.87	3.35	RT1817
90.74	56	5.91	22	5.91	-	-	4.92	0.91	2.36	2.09	2.60	RT2111
284.43	139	6.69	56	6.69	22.2	6.30	7.87	1.34	3.54	3.27	3.94	RT2119
143.96	89	5.91	35	5.91	-	-	6.30	0.98	3.15	2.60	3.50	RT3311
537.99	223	7.87	89	7.87	34.8	7.87	9.84	1.73	4.33	4.37	4.84	RT3323